

# ESHRE 2023

Bella Center Copenhagen, Denmark

25 – 28 June 2023



[www.eshre.eu](http://www.eshre.eu)  
European Society of Human Reproduction and Embryology

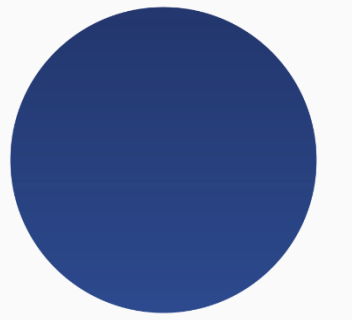



# Welcome & thank you for being here

At ESHRE 2022 we hosted a total of 174 exhibiting companies

- 169 commercial exhibitors
- 5 non-commercial exhibitors

=> Total net surface of 4,864 m<sup>2</sup>



# Registrations @ ESHRE 2022

- Participants registered for the main programme = **10,050**
- Exhibitors & Visitors exhibit = **1,950**
- Press registrations = **33**

**=> Overall total = 12,033**

10,050 registered participants for the main programme include



In-person scientific programme = 81%

Virtual scientific programme = 19%

ESHRE 2021 (virtual) = 9,142



ESHRE 2021 vs 2022

## Main Programme

ESHRE  
2021  
Virtual

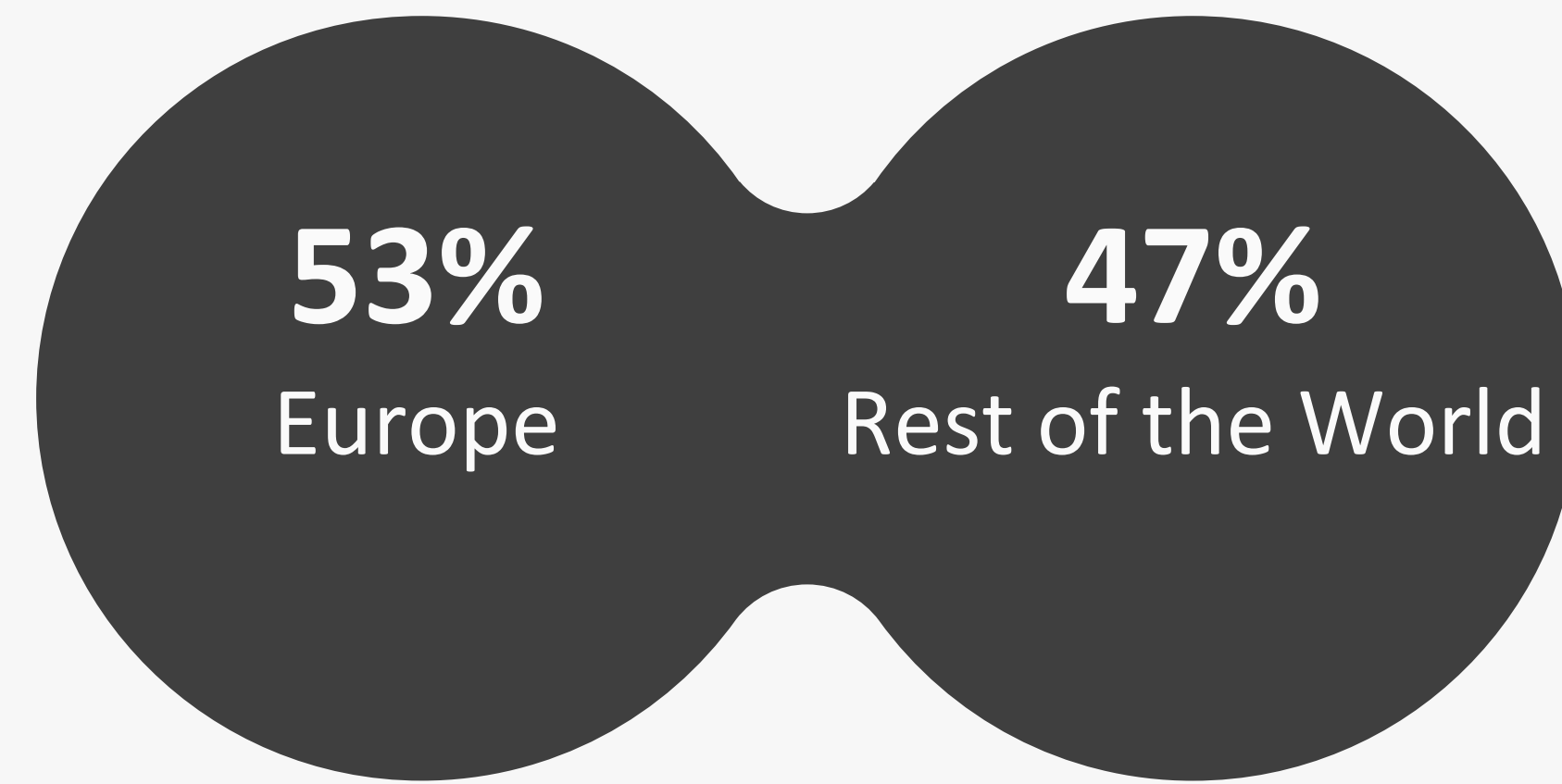

ESHRE  
2022  
Hybrid

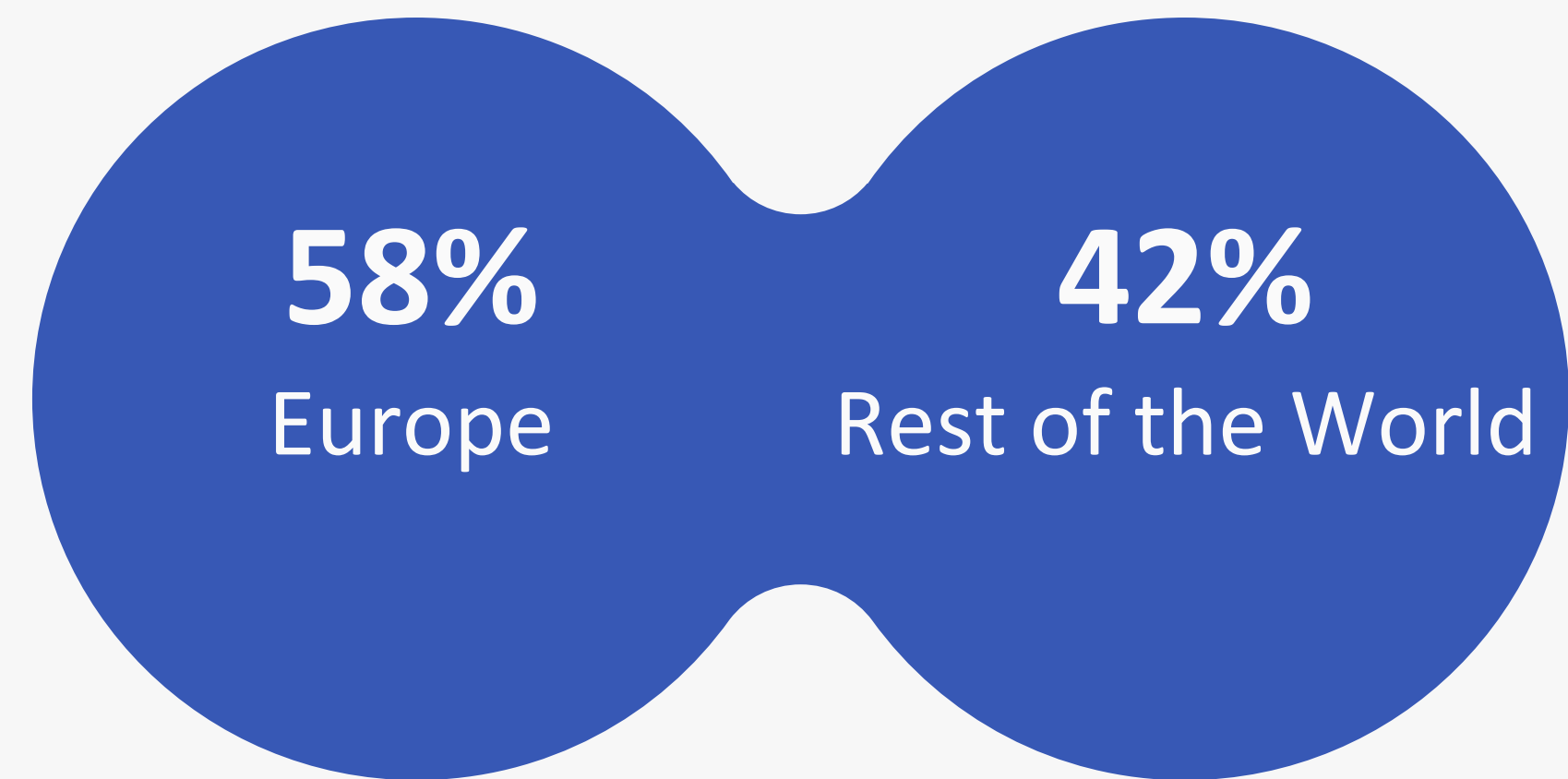



ESHRE 2021 vs 2022

# Main Programme / Geographical distribution

## ESHRE 2021

127 Countries represented

### Top 10 Europe

United Kingdom	488
Spain	465
Germany	321
Italy	320
France	291
Belgium	244
The Netherlands	192
Greece	171
Turkey	171
Switzerland	162

### Top 10 Rest of the World

India	448
U.S.A.	260
Thailand	222
Mexico	177
Brazil	168
China	141
Saudi Arabia	135
Peru	126
Argentina	112
Vietnam	112

## ESHRE 2022

130 Countries represented

### Top 10 Europe

Italy	764
United Kingdom	546
Spain	530
France	394
Germany	371
Poland	243
The Netherlands	241
Belgium	213
Turkey	209
Denmark	198

### Top 10 Rest of the World

India	383
U.S.A.	273
Iraq	266
Brazil	199
China	176
Thailand	170
Egypt	169
Israel	161
Australia	127
Mexico	126





# Main Programme / Geographical distribution

## 500 and more

Italy
United Kingdom
Spain

## 250 and more

France
India
U.S.A.
Germany
Iraq
The Netherlands
Switzerland

## 100-249

Turkey	Czech
Brazil	Republic
Greece	Mexico
China	Austria
Egypt	Saudi Arabia
Belgium	Portugal
Denmark	Ukraine
Israel	Jordan
Thailand	Taiwan R.O.C.
Romania	Algeria
Sweden	Japan
Australia	

## 50-99

United Arab Emirates	Ireland
Russia C.I.S.	Bulgaria
Hungary	Norway
Argentina	Georgia
Canada	Malaysia
Serbia	Nigeria
Tunisia	Indonesia
Vietnam	Singapore Rep. of
Kazakhstan	Finland
Peru	Lebanon
	South Africa





ESHRE2022

## Main Programme / Geographical distribution

49 and less

Albania
Armenia
Azerbaijan
Bahrain
Bangladesh
Belarus
Bosnia - Herzegovina
Brunei
Chile
Colombia
Comoros
Costa Rica
Croatia
Croatia
Cuba
Curaçao
Cyprus
Dominican Republic
Ecuador
Estonia

Ethiopia
Ghana
Guadeloupe
Guatemala
Guyana
Honduras
Hong Kong
Iceland
Iran
Ivory Coast
Jersey
Kenya
Korea, South
Kosovo
Kuwait
Kyrgyzstan
Latvia
Libya
Liechtenstein
Lithuania

Luxembourg
Macau
Macedonia
Mali
Malta
Martinique
Mauritius
Moldova
Monaco
Mongolia
Montenegro
Morocco
Nepal
New Zealand
Nicaragua
Niger
Oman
Pakistan
Palestine
Panama

Paraguay
Philippines
Puerto Rico
Qatar
Saint Kitts and Nevis
Slovakia
Slovenia
Sri Lanka
Sudan
Syria
Tanzania
Togo
Trinidad and Tobago
Uganda
Uruguay
Uzbekistan
Venezuela
Yemen
Zimbabwe



# ESHRE 2022 – Registered Participants

## Geographical

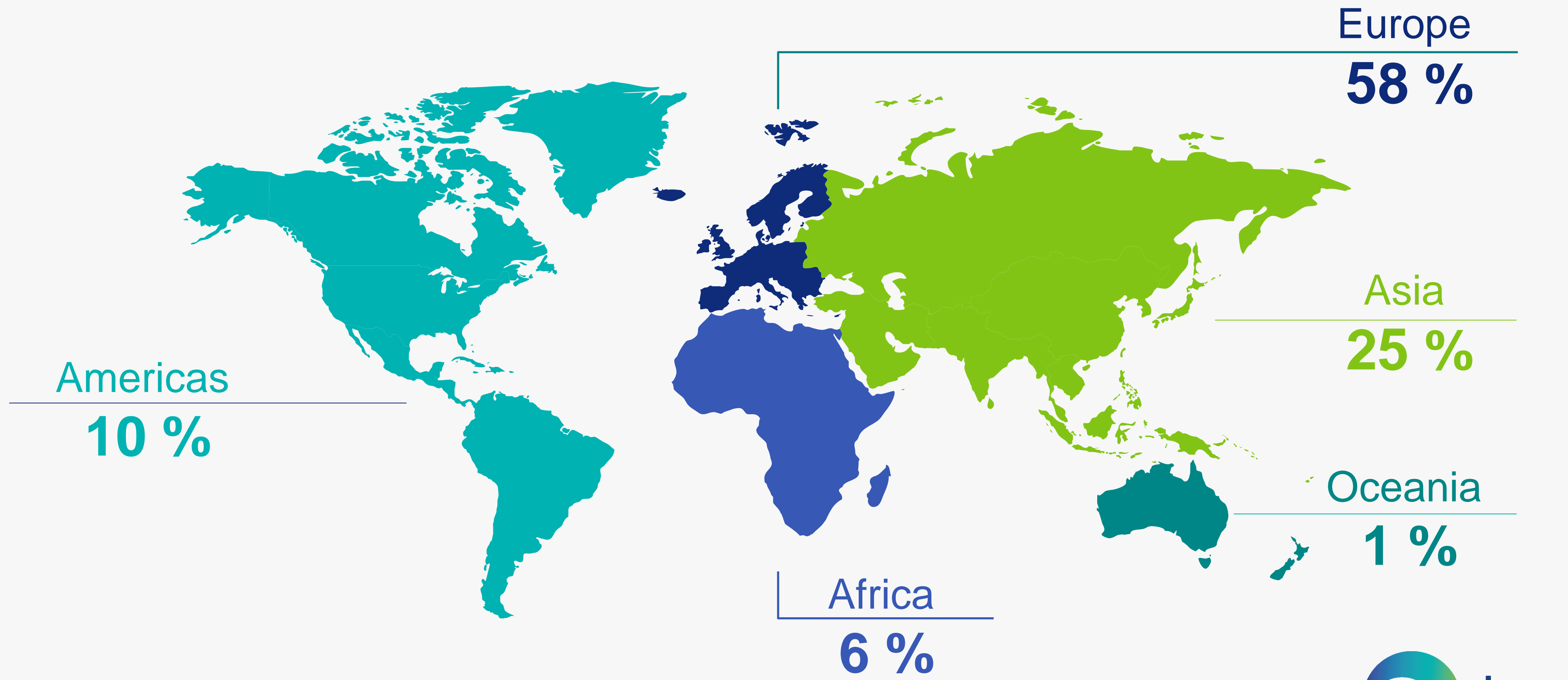





# ESHRE 2022 – Engagement / Views

## Virtual attendance

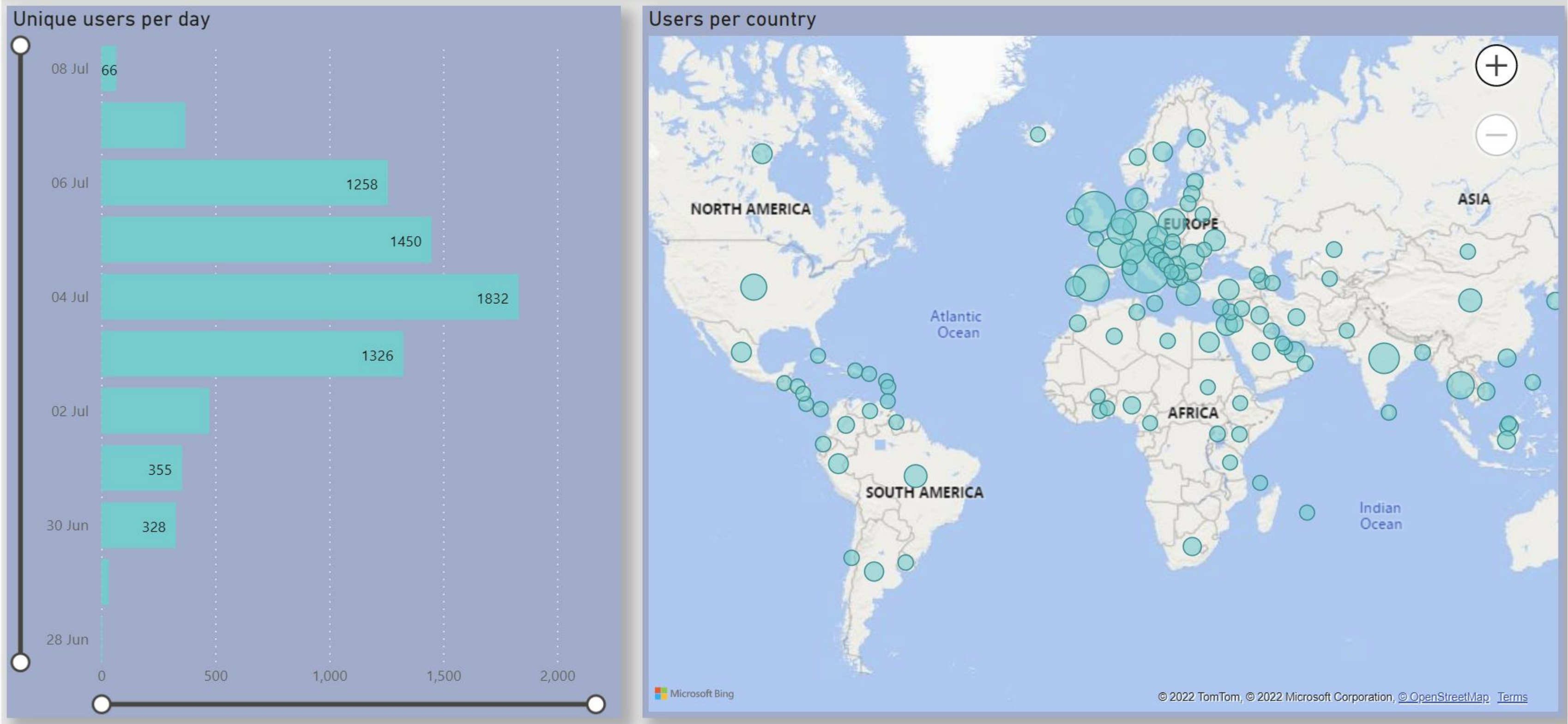



# ESHRE 2022

## Participants Main programme by Occupation

- Embryologist
- Company representative
- Other Occupation
- Unknown
- Basic (research) scientist
- Resident/student
- Pharmacist
- Nurse
- Lab technician
- Midwife
- Psychologist/Counsellor

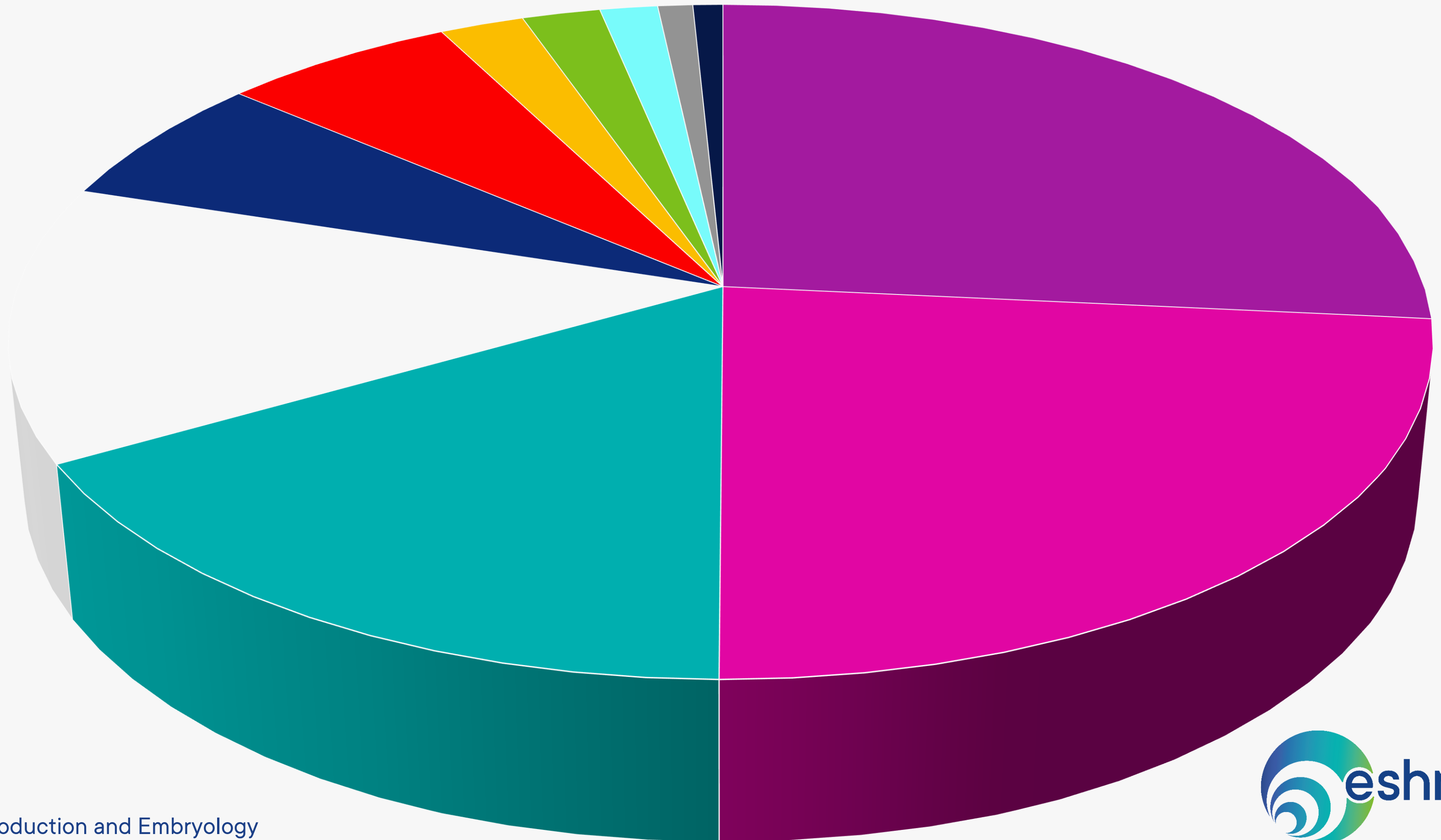





# ESHRE 2023 - Programme



[www.eshre.eu](http://www.eshre.eu)  
European Society of Human Reproduction and Embryology







# ESHRE 2023 Web pages

Information already available on:  
<https://www.eshre.eu/ESHRE2023>

This is the second time ESHRE will host its annual meeting in Copenhagen. The last time was 2005.

The screenshot shows the top section of the ESHRE 2023 website. The main banner features a vibrant image of a Copenhagen street with colorful buildings and a sailboat. Overlaid on the image is the text: **ESHRE 39th Annual Meeting** in large green letters, followed by **Copenhagen, Denmark** and **25-28 June 2023** in white. Below this is the hashtag **#ESHRE2023** and a blue button that says "Welcome to Copenhagen". At the bottom of the banner is a navigation bar with links: GENERAL INFO, PROGRAMME, EXHIBIT AND SPONSORS, REGISTRATION, PLAN YOUR TRIP, and CONTACT US. Below the banner, there is a section titled "Welcome to ESHRE 2023! Welcome to Copenhagen!" with a welcome message and details about the meeting.

**ESHRE 39th Annual Meeting**  
Copenhagen, Denmark  
25-28 June 2023  
#ESHRE2023  
Welcome to Copenhagen

GENERAL INFO PROGRAMME EXHIBIT AND SPONSORS REGISTRATION PLAN YOUR TRIP CONTACT US

Copenhagen, Denmark  
25 — 28 June 2023

**ESHRE 39th Annual Meeting**

**Welcome to ESHRE 2023! Welcome to Copenhagen!**

It is our great pleasure to invite you to join us in wonderful Copenhagen from 25 to 28 June 2023 for the 39th Annual Meeting of ESHRE.

After a successful and much welcomed post-lockdown meeting in Milan 2022 we hope to repeat the success by offering you a warm, friendly and exciting setting in one of the most beautiful cities in Europe in what is probably the best month of the year to visit our country. The days are long, the light is exceptional and the air is warm (we hope!).



# ESHRE 2023 - Website

**Beware of cyber squatting!** – the only trusted website is [www.eshre.eu](http://www.eshre.eu) or

<https://www.eshre.eu/Annual-Meeting/ESHRE-2023> or

<https://www.eshre.eu/ESHRE2023>

**In case of doubt, please contact us!**

**Our official housing agent → MCI COPENHAGEN**

**Official housing site & booking form on**

<https://b-com.mci->

[group.com/CommunityPortal/ProgressivePortal/ESHRE2023/App/Views/InformationPage/View.aspx?InformationPageID=16853](https://b-com.mci-group.com/CommunityPortal/ProgressivePortal/ESHRE2023/App/Views/InformationPage/View.aspx?InformationPageID=16853)





# ESHRE 2023 – The Venue



[www.eshre.eu](http://www.eshre.eu)

European Society of Human Reproduction and Embryology







# ESHRE 2023 – The venue

**Will be held at:**

Bella Center Copenhagen

**Address:**

Center Boulevard 5

2300 Copenhagen

Denmark



Info see <https://www.bellacentercopenhagen.dk/en-GB/Home.aspx>



# ESHRE 2023 – The venue

The **Exhibition** will be organised on the ground floor in

- Hall C (HALL C1-C4)
- HALL E (NORTH + SOUTH)
- Main entrances venue through 4 & 5

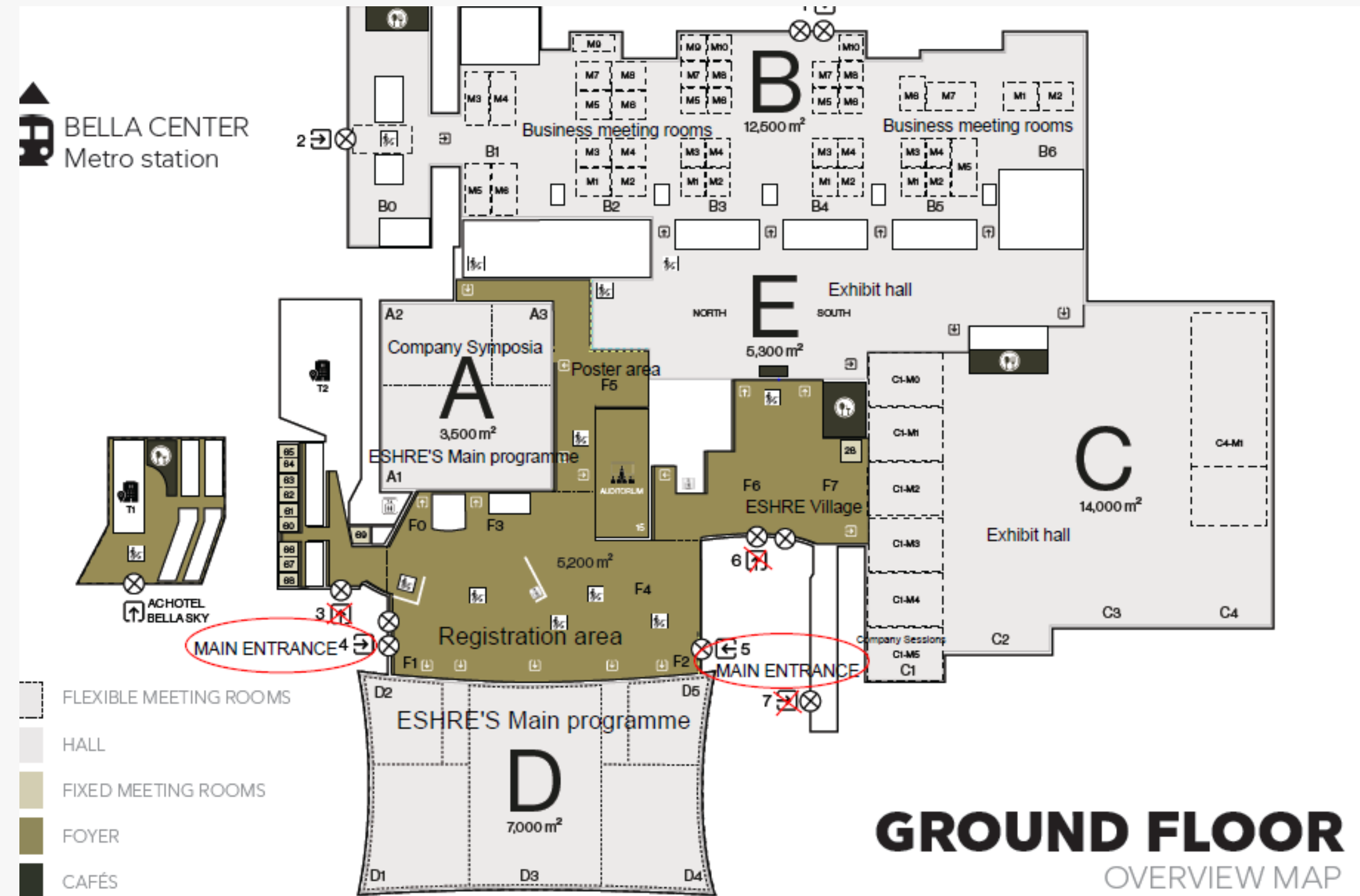



# ESHRE 2023 – The venue

The **Company Symposia and Main programme** will be held at Hall A (ground floor) – offering room for approx. 3500 to 4000 delegates

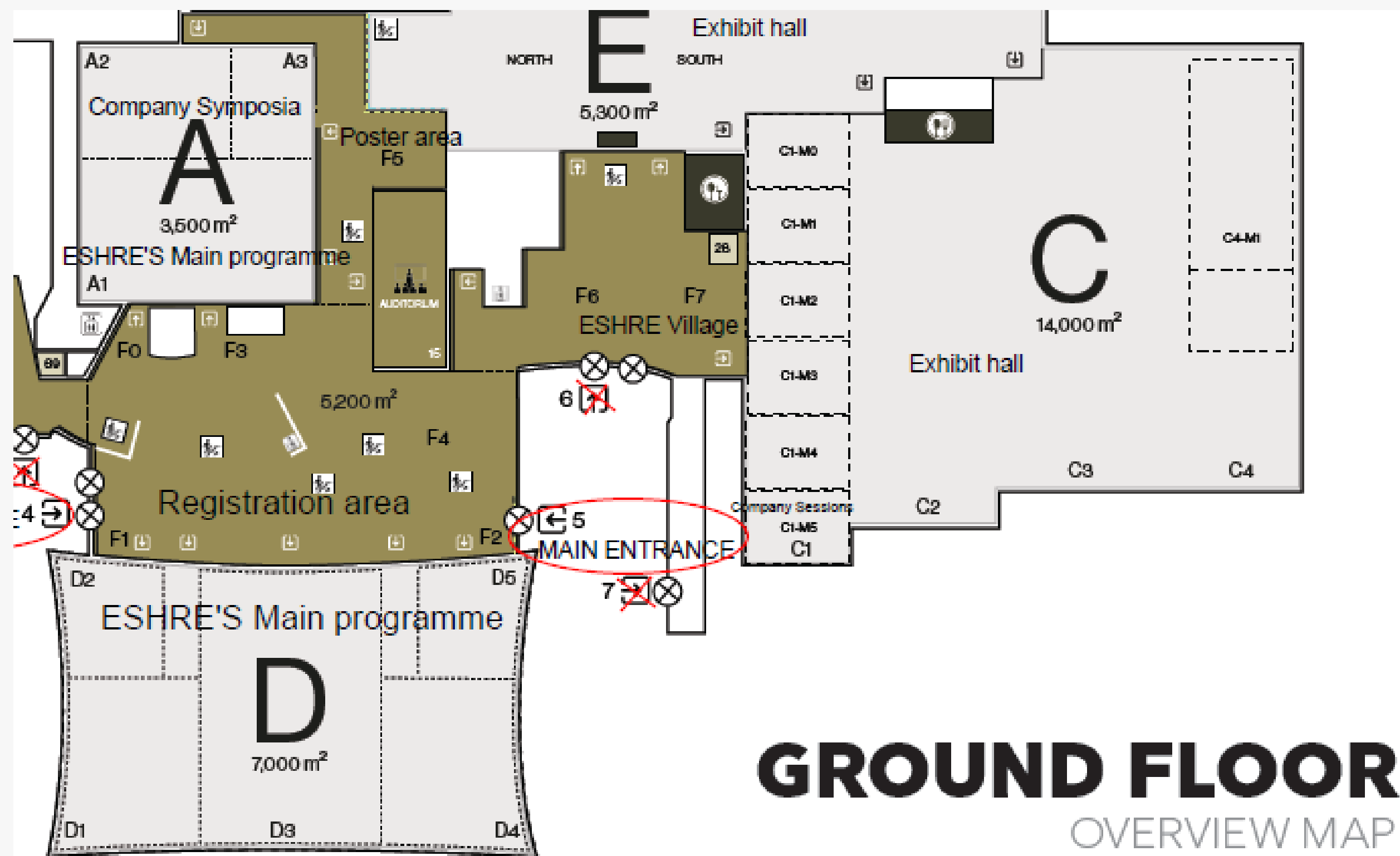



# ESHRE 2023 – The venue

The **Company Sessions** will be held at C1-M5 in exhibition hall C - offering room for approx. 450 delegates

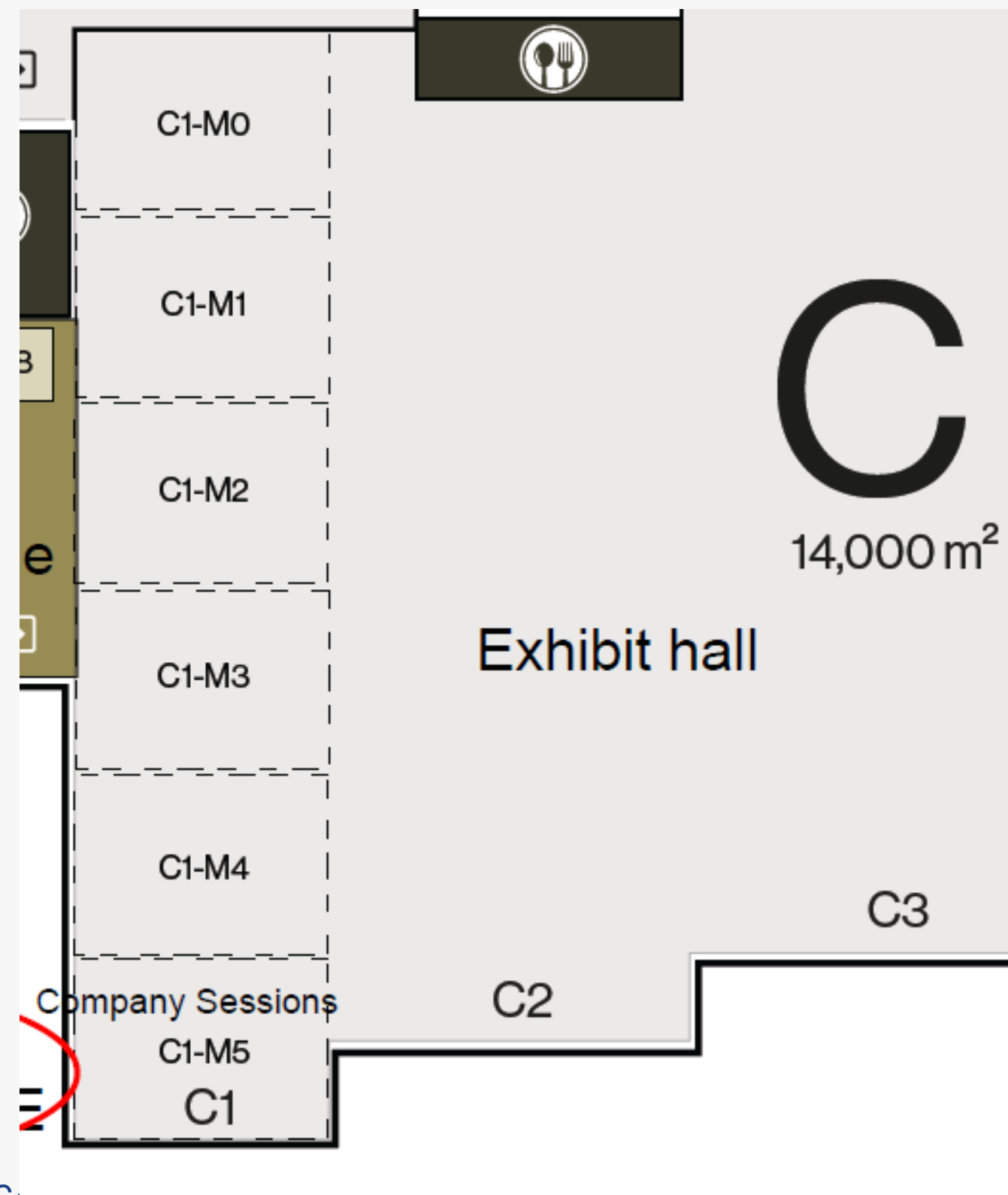



# ESHRE 2023 – Meeting rooms

Meeting rooms will be available for business meetings at the Bella Center and at the Bella Sky Hotel.

Please send your request to [ESHRE2023Meetings@bellacenter.dk](mailto:ESHRE2023Meetings@bellacenter.dk)

# Exhibit at ESHRE 2023



[www.eshre.eu](http://www.eshre.eu)

European Society of Human Reproduction and Embryology







# ESHRE 2023 – Booth types

The following booth types will be offered:

## **FLOOR SPACE ONLY** (up to max. 243m<sup>2</sup>)

Floor space only: is a booth space without a shell scheme. It is the Exhibitor's responsibility to take care of the design, set-up, installation and dismantling of the booth

## **FLOOR SPACE + SHELL SCHEME** (up to max. 27m<sup>2</sup>)

Floor space + shell scheme: is a booth space including a shell scheme which is designed for exhibitors who do not design and construct their own stand. It is set up and dismantled by the official congress stand builder

Please note that your booth space should be separated from your neighbouring exhibitors by means of a wall.

-> Furniture, graphics, extra electricity, etc. are at an additional cost and can be rented through the webshop of the congress stand builder (available as from January 2023)

### The shell scheme includes:

- Carpet flooring (choice of 10 standard colours)
- White wall panels L100 x H250 cm
- Company name on each open side
- Spotlights 1 per 3 square metres (3m<sup>2</sup>)
- 2,3kW – 1 triple socket
- Build-up and dismantling
- Daily cleaning inside the booth (floor cleaning and emptying bins)





# ESHRE 2023 – Visual shell scheme

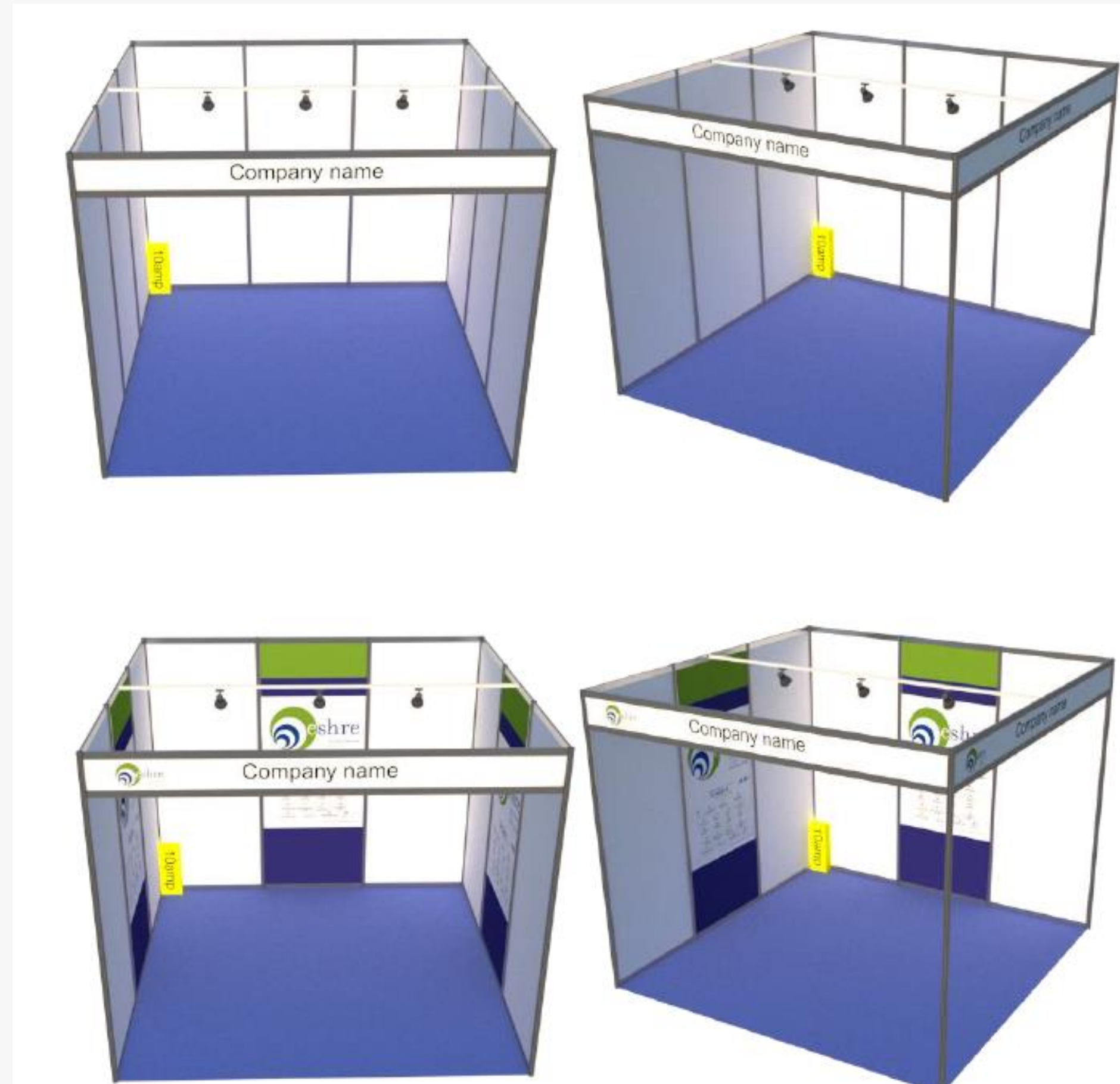



# ESHRE 2023 – Booth fees

Booth type	Floor space only Euro per m <sup>2</sup> , excl. VAT	Floor space + shell scheme Euro per m <sup>2</sup> , excl. VAT
Inline booth (i.e. 1 side open towards aisle)	405	499
Corner booth (i.e. 2 sides open towards aisle)	425	524
Peninsula booth (i.e. 3 sides open towards aisle)	446	549
Island booth (i.e. 4 sides open towards aisle)	466	/

Furniture, graphics, electricity, etc. are at an additional cost and can be rented in the webshop of the congress stand builder (available at the beginning of January)



# ESHRE 2023 – Virtual Exhibitor Page

A virtual exhibitor page is included in the space rental based on the square metres that you are booking:

- Basic package for floor spaces from 9m<sup>2</sup> to 99m<sup>2</sup>
- Superior package for floor spaces from 100m<sup>2</sup> to 198m<sup>2</sup>
- Premium package for floor spaces from 199m<sup>2</sup> to 243m<sup>2</sup>

The virtual exhibitor page will be available on the desktop platform and in the congress app of the Annual Meeting.



# ESHRE 2023 - Exhibitor benefits

## Exhibit – what's included?

- . Exposure at all exhibit hall events:
  - Welcome Reception on Sunday evening 25 June 2023 at 20:00
  - 3 lunch breaks and 5 coffee breaks
- . Exclusive hours with no competing scientific sessions during the Welcome Reception, lunch and coffee breaks
- . Free access to the Opening Ceremony on 25 June at 19:00
- . Complimentary lunch and coffee for all exhibitors and delegates in the exhibit halls
- . Stand holders are entitled to a number of free badges depending on the booth size



# ESHRE 2023 - How to book a booth space

## ONLINE BOOKING FORM

- You can book your booth space through  
<https://www.eshre.eu/ESHRE2023/Exhibit%20and%20Sponsors/Exhibition%20order%20form>

Important:

- You need to log in to access the form
- In case you don't have an account yet, then please create your personal account via the following link: <https://www.eshre.eu/ESHRE/CreateAccount#createaccount>





# ESHRE 2023 – Badges Stand holders

Stand holders are entitled to a number of free Exhibitor badges and Full programme badges, depending on the size of the exhibit space.

Summary table outlining free exhibitor and full programme badges

Booth size	Free Exhibitor badges	Free Full programme badges
9 m <sup>2</sup>	2	1
10-18 m <sup>2</sup>	4	1
19 – 44 m <sup>2</sup>	8	1
45 – 71 m <sup>2</sup>	16	2
72 – 90 m <sup>2</sup>	26	2
91 – 152 m <sup>2</sup>	40	3
153 – 200 m <sup>2</sup>	60	4
201 – 243 m <sup>2</sup>	75	4



# ESHRE 2023 – Badges Stand holders

## Free & payable Exhibitor badges

### FREE EXHIBITOR BADGES

- give in-person and virtual access to the exhibition and to the sponsored sessions held in real-time for the duration of the sessions
- give on-demand access to the virtual exhibit and sponsored sessions (for 6 months after the meeting has been held)
- These badges do not include access to the official scientific programme (i.e. pregress courses and main programme)

### PAYABLE EXHIBITOR BADGES

- If you would like to order additional exhibitor badges on top of the free badges, then the price is 125 Euro excl. VAT per exhibitor badge.
- This is a discount price for stand holders. Non-stand holders who only wish to visit the exhibition and sponsored sessions have to pay 300 Euro excl. VAT





# ESHRE 2023 – Badges Stand holders

## Free & payable Full programme badges

### FREE FULL PROGRAMME BADGES

- give in-person and virtual access to the scientific programme, sponsored sessions and exhibition held in real-time for the duration of the congress
- give on-demand access to the virtual meeting platform for 6 months after the meeting has taken place

### PAYABLE FULL PROGRAMME BADGES

- If you would like to order additional Full programme badges on top of your free programme badge(s), then you can order these on [Registration ESHRE Annual Meeting](#) (Individual registration or Group registration if more than 10 people)

Stand holders will receive a link from ESHRE to order their free (and payable) exhibitor badges at a later stage.



# ESHRE 2023 - Exhibit

## Building restrictions booths

*No exceptions will be made!*

- Minimum exhibit space = 9 m<sup>2</sup>
- Maximum exhibit space = 243 m<sup>2</sup> (i.e. total of 27 units of 9 m<sup>2</sup>)
- The bookable aisles can also be booked in units of 9m<sup>2</sup> (3m x 3m). So you can use the bookable aisles as a space to construct your stand. The emergency aisles must be kept free of stands
- Maximum building height Island booths: 3,5 or 4 metres (depending on your location)
- Maximum building height Inline, Corner and Peninsula booths: 2,5 metres (back and side walls)
- Banners Island, Inline, Corner and Peninsula booths: the bottom height for banners will be 4 or 4,5 metres  
Banners can measure maximum 1.5m, which brings the overall possible maximum height up to 5,5 or 6 metres
- No banners are possible in C1
- In order to create an open environment at the exhibit, only 1/3 of each stand's side facing an aisle may be covered by a wall

All custom-made booth plans will need to be reviewed and approved by ESHRE.

**Booth plans should be in by 2 May 2023 at the very latest.**



# ESHRE 2023 - Building Restrictions

## Island booths

Hall C – Section C1: no banners possible, wall height is 4m, overall height is 4m

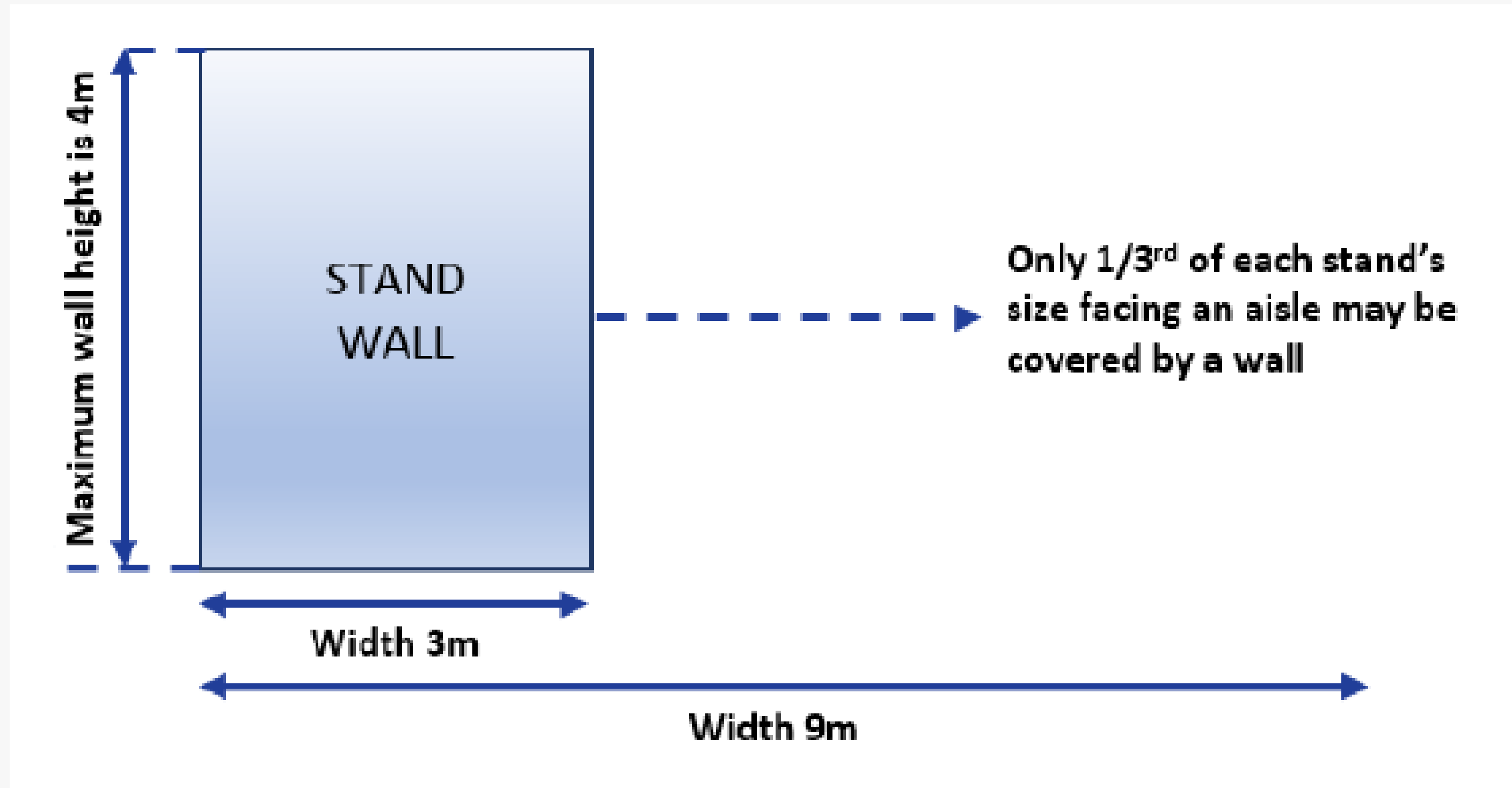



# ESHRE 2023 - Building Restrictions

## Island booths

Hall C – Section C2: wall height is 3,5m and overall height is 5,5m

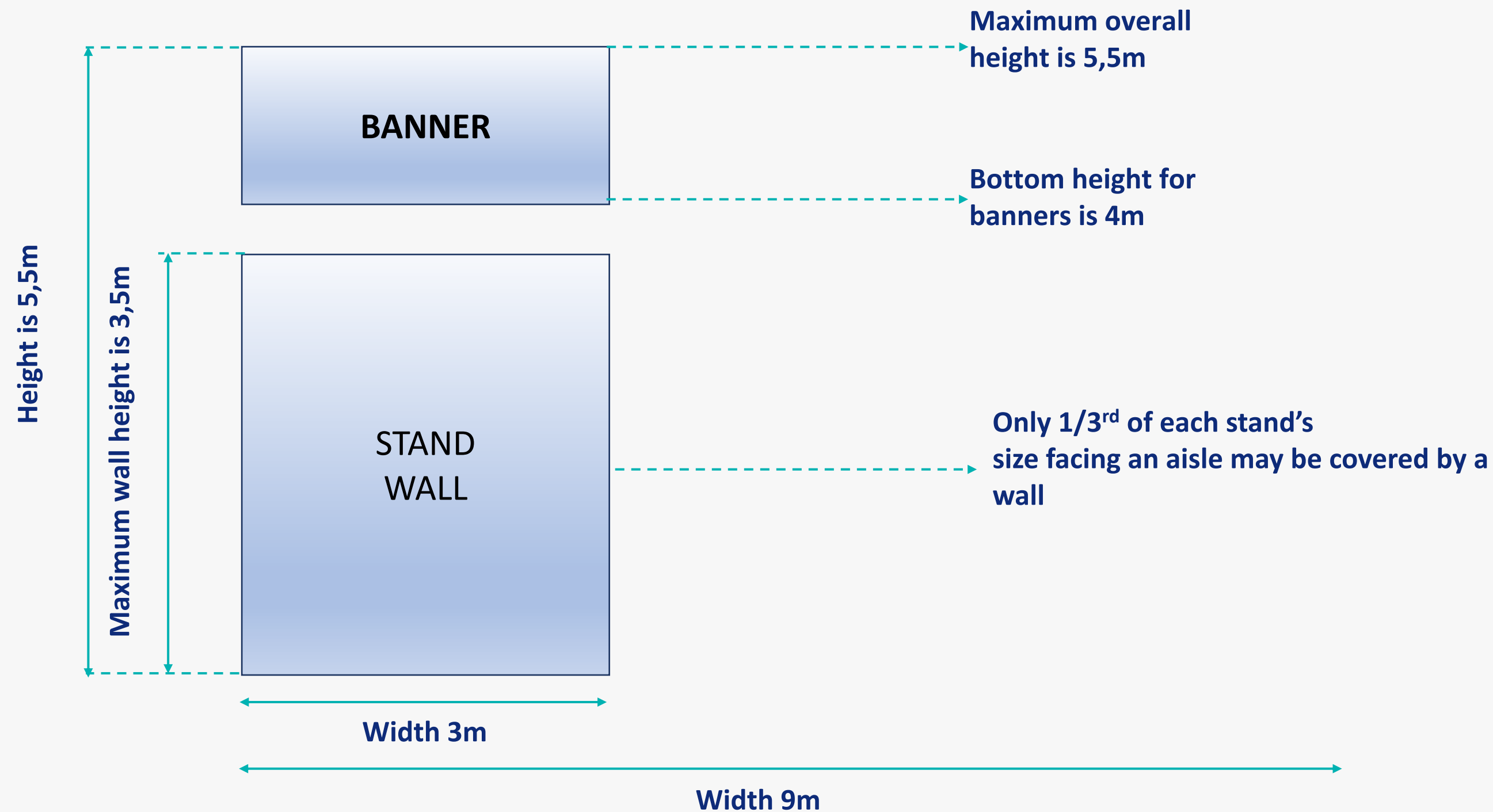





# ESHRE 2023 - Building Restrictions

## Island booths

Hall C - Section C3 & C4 + Hall E: wall height is 4m and overall height is 6m

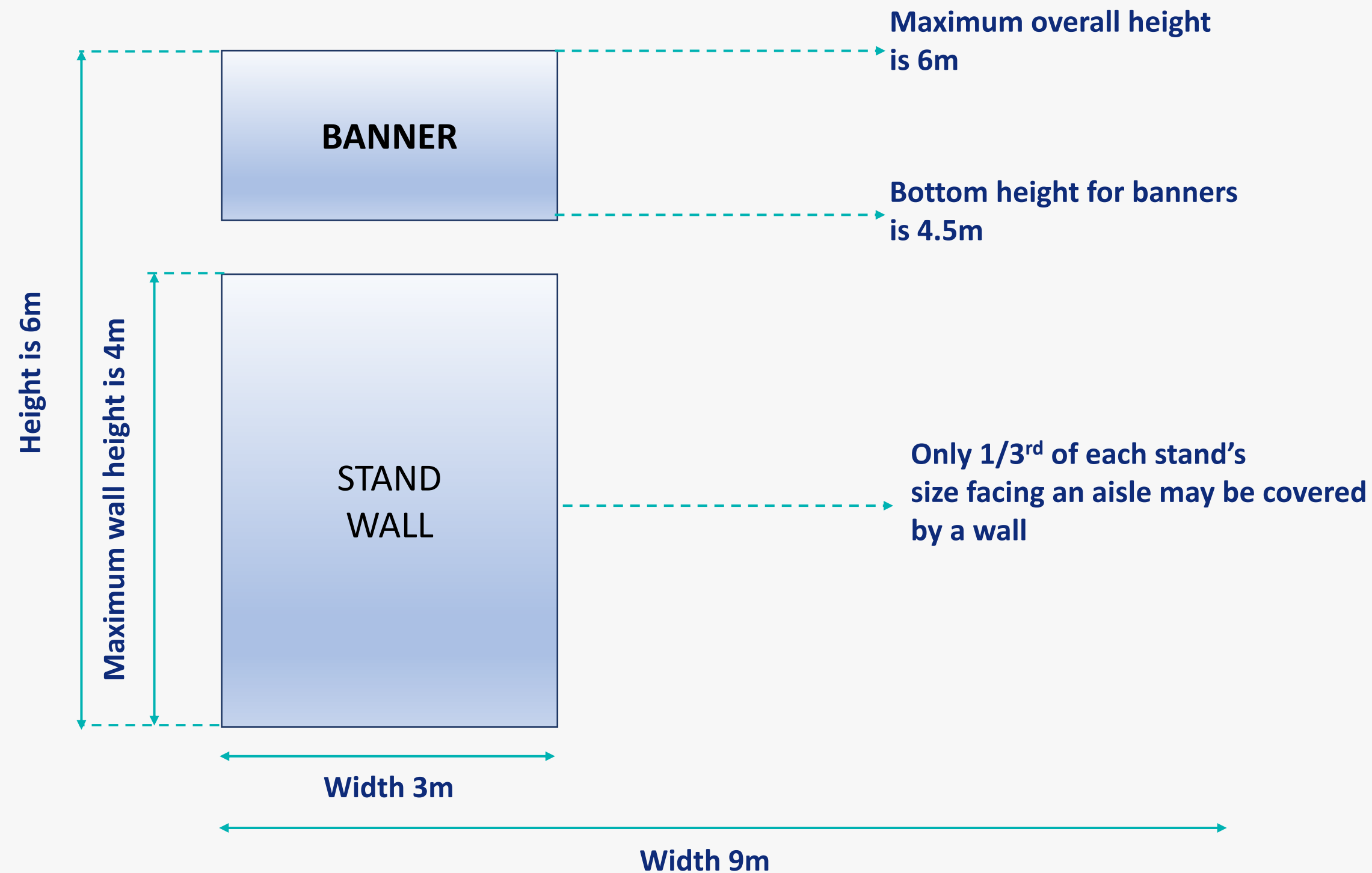



# ESHRE 2023 - Building Restrictions

## Inline, Corner and Peninsula booths

Hall C – Section C1: no banners possible, wall height is 2,5m and overall height is 2,5m

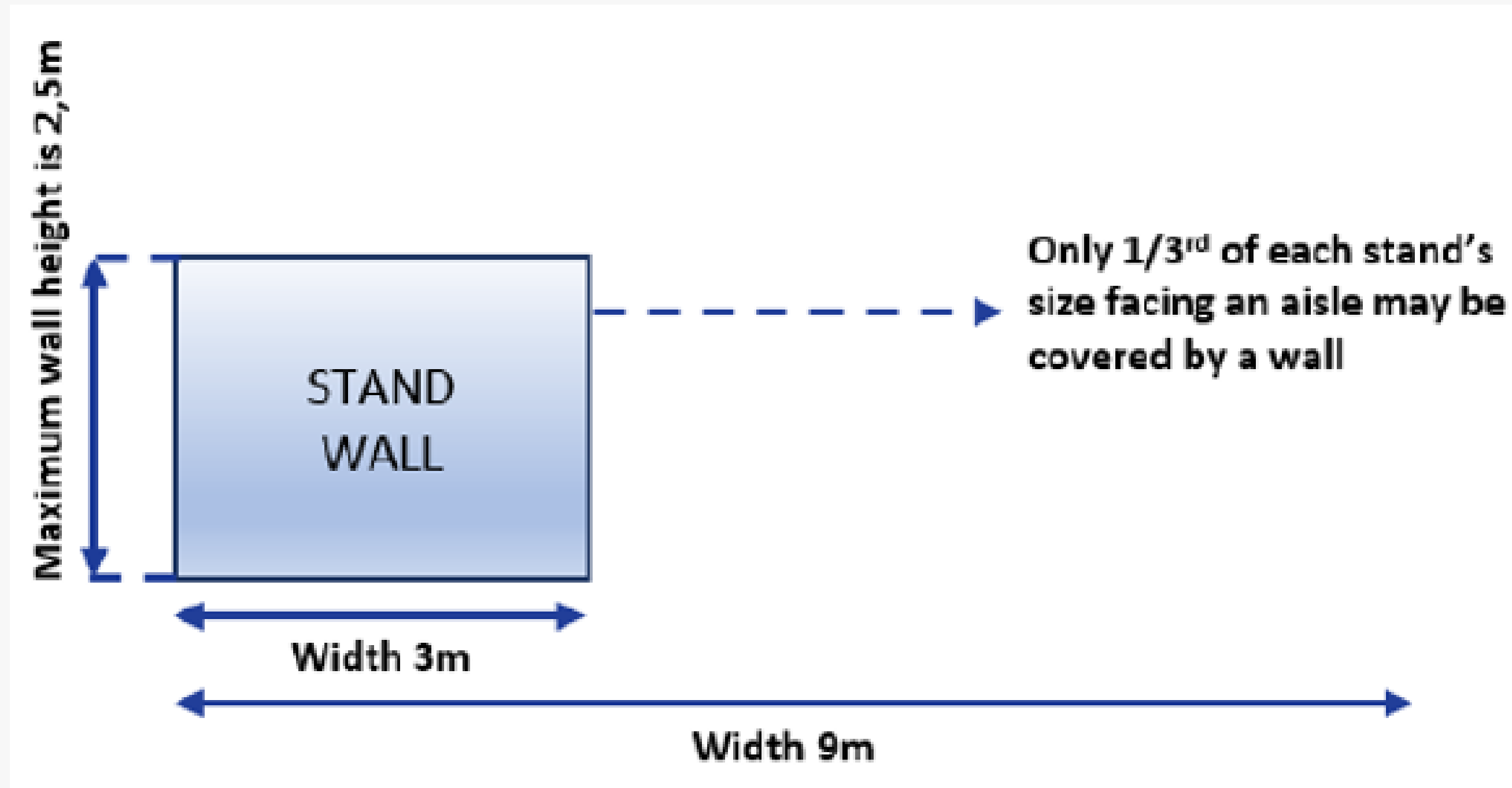



# ESHRE 2023 - Building Restrictions

## Inline, Corner and Peninsula booths

Hall C – Section C2: wall height is 2,5m and overall height is 5,5m

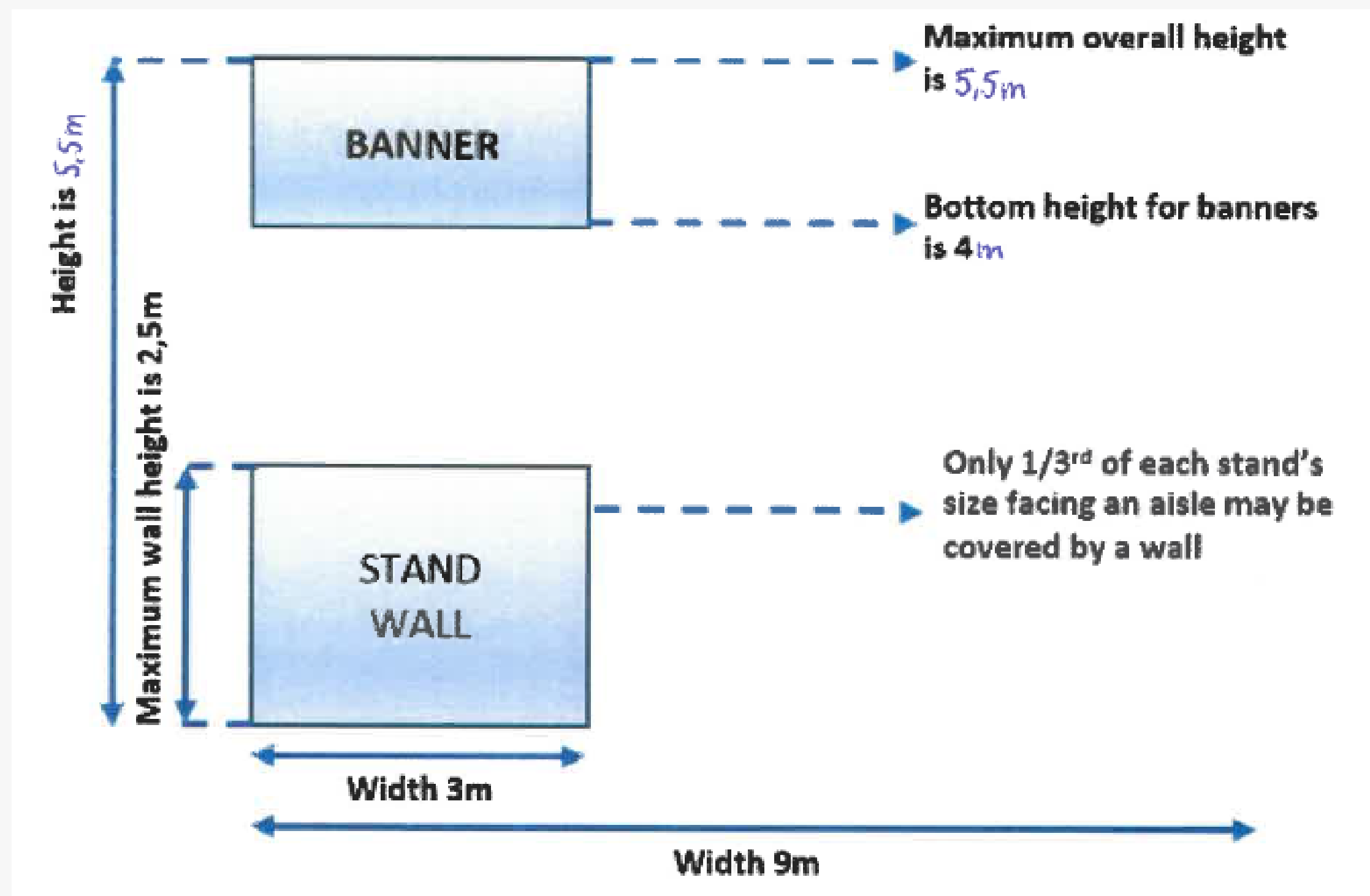



# ESHRE 2023 - Building Restrictions

## Inline, Corner and Peninsula booths

Hall C - Section C3 & C4 + Hall E: wall height is 2,5m and overall height is 6m

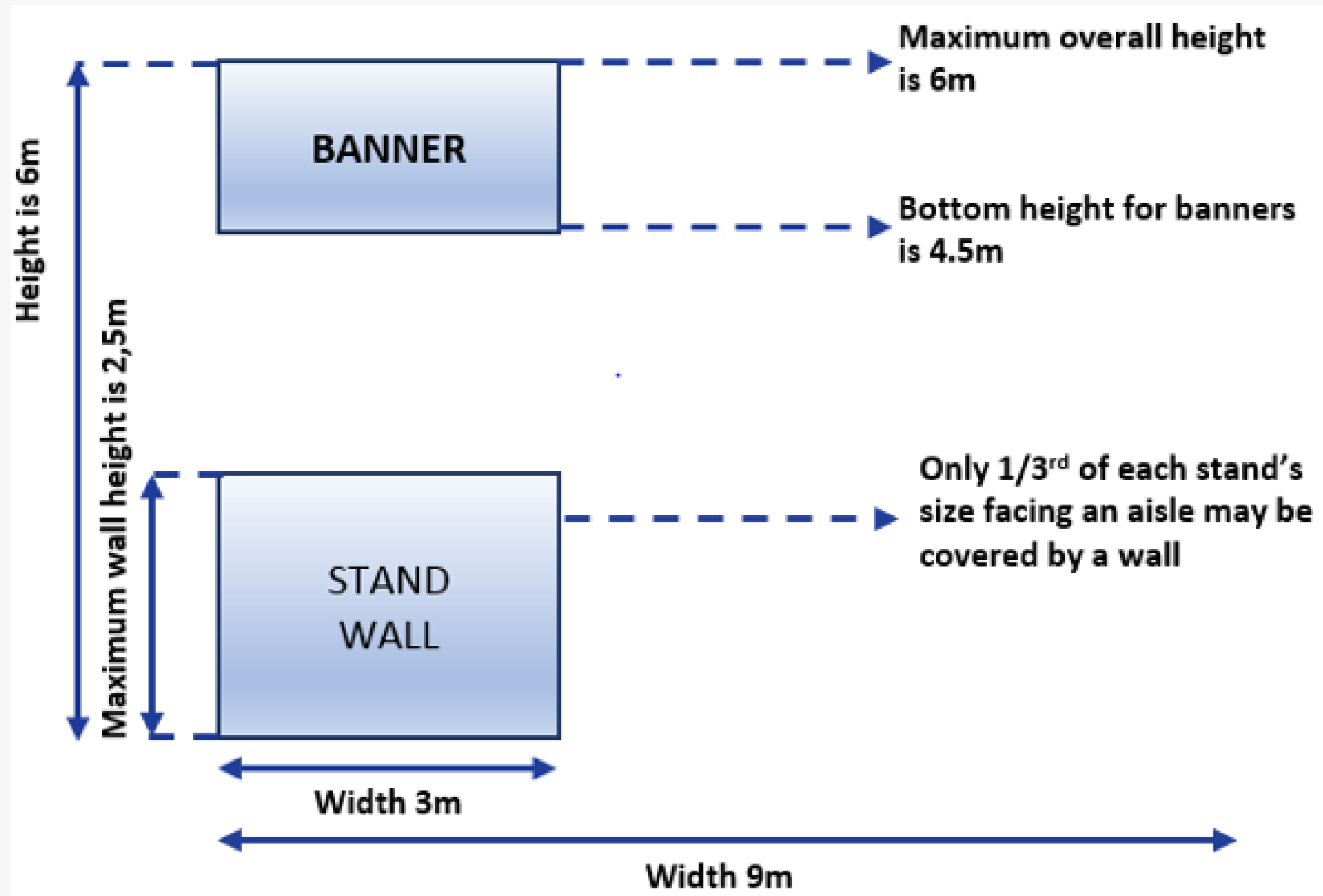





# ESHRE 2023 - Exhibit

## Exhibit build-up

Times are subject to change

Thursday, 22 June 2023 from 08:00 to 22:00

Friday, 23 June 2023 from 08:00 to 22:00

Saturday, 24 June 2023 from 08:00 to 22:00\*

Sunday, 25 June 2023 from 08:00 to 17:00\* (Welcome reception as from 20:00)

### ○ Saturday, 24 June :

- All booths need to be finished !
- Aisles need to be cleared and all empties need to be moved out
- All aisles need to be clean and empty

### ○ Sunday, 25 June :

- No material can be brought in anymore
- All aisles need to be clean and empty
- Only booth decoration inside the booth is allowed
- No “dirty” works are allowed



# ESHRE 2023 - Exhibit



## Exhibit opening dates / hours for visitors exhibit

Sunday, 25 June	from 20:00 to 22:00 (Welcome Reception in exhibit hall for all delegates)
Monday, 26 June	from 08.30 to 17:00
Tuesday, 27 June	from 08.30 to 17:00
Wednesday, 28 June	from 08.30 to 14:00

From Monday, 26 June to Wednesday, 28 June stand holders will already have access to the exhibit areas as of 07:30



# ESHRE 2023 - Exhibit



**Welcome reception, lunch and coffee breaks**

**Welcome Reception at the exhibit areas on :**

Sunday, 25 June, at 20:00 (official start of the congress and opening of the exhibit)

**Lunch and coffee breaks at the exhibit areas :**

- Lunch breaks on Monday, Tuesday, Wednesday from 13:00 until 14:00
- 2 Coffee breaks on Monday & Tuesday
  - Morning coffee breaks from 09.30 until 10:00
  - Afternoon coffee breaks from 16:30 until 17:00
- 1 Coffee break on Wednesday
  - Morning coffee break from 09.30 until 10:00 (no afternoon coffee break)



# ESHRE 2023 - Exhibit

## Exhibit dismantling

Wednesday, 28 June 2023

Thursday, 29 June 2023

## Times are subject to change

from 15:00 to 24:00

from 08:00 until 17:00 (times may change)

Times are subject to change.

## Please note the following:

On Wednesday the exhibit will be closed to visitors as of 14:00 (end of the last lunch break).

Dismantling can only start once the exhibit hall has been cleared of all visitors at 15:00.



# Company Symposium

- Increase your visibility among experts in reproductive medicine
- Enhance your brand awareness
- Educate and engage with a large audience
- Showcase your products, technologies, treatments and research



6 time slots available

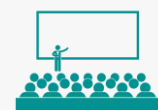

Largest session hall –  
Hall A  
3500 to 4000 pax



Room rental and standard AV included



According to ranking list







# ESHRE 2023 – Company Symposia

## Prices time slots

**Monday, 26 June 2023**

Time Slot	Price Time Slot (incl. on demand) Euro excl. VAT	Credits Time Slot
11:45 – 13:00	48000	55
14:00 – 15:15	43000	50
17:00 – 18:15	33000	40

Start Scientific programme:	08:30
Coffee break	09:30-10:00
Lunch break	13:00-14:00
Coffee break	16:30-17:00
End	18:00



# ESHRE 2023 – Company Symposia

## Prices time slots

**Tuesday, 27 June 2023**

Time Slot	Price Time Slot (incl. on demand) Euro excl. VAT	Credits Time Slot
<b>11:45 – 13:00</b>	48000	55
<b>14:00 – 15:15</b>	43000	50
<b>17:00 – 18:15</b>	33000	40

Start Scientific programme:	08:30
Coffee break	09:30-10:00
Lunch break	13:00-14:00
Coffee break	16:30-17:00
End	18:00
Annual General Assembly	18:00-19:00



# ESHRE 2023 – Company Symposia

## Prices Recording types

Recording type	Price Euro excl. VAT
Recording + Livestream	6500
Recording Only	3000

### Recording + Livestream:

Your in-person session is simultaneously recorded and broadcast in real-time over the internet. Online participants can engage by sending questions, which you can answer in real time.

### Recording only:

Your in-person session is only recorded. Your session will not be broadcast in real-time and so there won't be any online participants.

### Contract

The 'Recording + Livestream' or 'Recording only' should be booked through our IT provider COVR. We will send you their contract once your session time slot has been confirmed.





# Company Session

- Interact with participants in an intimate setting
- Present your new and existing products
- Increase your visibility and enhance your brand awareness
- Share your research outcomes



Several time slots available



Room rental and standard AV included

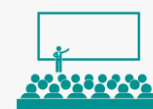

Room for 450 pax



According to ranking list





# ESHRE 2023 – Company Sessions

## Prices time slots

**Monday, 26 June 2023**

Time Slot	Price Time Slot (incl. on demand) Euro excl. VAT	Credits Time Slot
09:30 – 10:30	20000	30
11:15 – 12:15	17000	20
13:00 – 14:00	20000	30
14:45 – 15:45	17000	20
16:30 – 17:30	15000	18

Start Scientific programme:	08:30
Coffee break	09:30-10:00
Lunch break	13:00-14:00
Coffee break	16:30-17:00
End	18:00





# ESHRE 2023 – Company Sessions

## Prices time slots

Tuesday, 27 June 2023

Time Slot	Price Time Slot (incl. on demand) Euro excl. VAT	Credits Time Slot
09:30 – 10:30	18000	25
11:15 – 12:15	15000	18
13:00 – 14:00	18000	25
14:45 – 15:45	15000	18
16:30 – 17:30	13000	15

Start Scientific programme:	08:30
Coffee break	09:30-10:00
Lunch break	13:00-14:00
Coffee break	16:30-17:00
End	18:00





# ESHRE 2023 – Company Sessions

## Prices time slots

**Wednesday, 28 June 2023**

Time Slot	Price Time Slot (incl. on demand) Euro excl. VAT	Credits Time Slot
09:30 – 10:30	15000	18
11:15 – 12:15	13000	15
13:00 – 14:00	15000	18

Start Scientific programme:	08:30
Coffee break	09:30-10:00
Lunch break	13:00-14:00
Coffee break	16:30-17:00
End	18:00



# ESHRE 2023 – Company Sessions

## Prices Recording types

Recording type	Price Euro excl. VAT
Recording + Livestream	6500
Recording Only	3000

### Recording + Livestream:

Your in-person session is simultaneously recorded and broadcast in real-time over the internet. Online participants can engage by sending questions, which you can answer in real time.

### Recording only:

Your in-person session is only recorded. Your session will not be broadcast in real-time and so there won't be any online participants.

### Contract

The 'Recording + Livestream' or 'Recording only' should be booked through our IT provider COVR. We will send you their contract once your session time slot has been confirmed.





# ESHRE 2023 – How to book a Company Symposium or Company session

## ONLINE BOOKING FORM

- You can book your sponsored session through <https://www.eshre.eu/ESHRE2023/Exhibit%20and%20Sponsors/Session%20order%20form>
- Important:
  - You need to log in to access the form
  - In case you don't have an account yet, then please create your personal account via the following link: <https://www.eshre.eu/ESHRE/CreateAccount#createaccount>



## Your contacts at ESHRE:

**Veerle De Rijbel** – Exhibit and Sponsorship  
Manager

[Veerled@eshre.eu](mailto:Veerled@eshre.eu) - +32 474 510 831

**Lieve Buggenhout** – Exhibit and Sponsorship  
Manager

[Lieve@eshre.eu](mailto:Lieve@eshre.eu) - +32 476 450 867



[exhibit@eshre.eu](mailto:exhibit@eshre.eu)