

TEKNISK INFO

TECHNICAL INFO

9. maj 2022 4.12 PM



Hal C

– en kort beskrivelse

Adgang til hallen

På tegningen kan du se numrene for de enkelte porte, der giver adgang til hallen.

Hallens frihøjder

Hver af hallens fire sektioner har sin egen frihøjde, målt fra gulv til underkant lamper:

C1: 4,30m, C2: 5,85m, C3: 6,85m, C4: 6,85m. Se side 13-14.

Belysning

Hallen er udstyret med permanente rigkonstruktioner med 150W Powerball Spots, farve 5000 kelvin, som skal tilkøbes jævnfør tilbud.

Til den generelle belysning hænger der (3x58 W) lysarmaturer.

Loft/Ophængning i loft

Netværk trækkes fra loftet.

Wirer: Grundlæggende kan der ophænges 1 wire pr. 3 meter med en maks. belastning på 99 kg.

Det er muligt at lave andre vægtberegninger / -fordelinger.

Kontakt venligst den Tekniske Koordinator for beregninger samt godkendelse

Bella Center forbeholder sig ret til evt. at tilpasse placering.

Taljepunkter og rigning:

Der kan rigges i spær. Der arbejdes med variable vægt, ift. loftets totalbelastning.

Detailtegningen indeholder information om riggepunkternes placering.

Hvis man har behov for ophæng i en position mellem to riggepunkter, kan det opnås med enten bridling eller ved at hænge et rig-stykke. Per riggepunkt kan der som udgangspunkt maksimalt hænges 200kg.

Se Rig info på side 15.

Har du brug for rigning, at bridle eller opsætte rig-stykke, bedes du kontakte din kontaktperson i Bella Center for muligheder, validering og tilbud.

Bella Center forbeholder sig ret til evt. at tilpasse placering.

Gulv

Gulvet er gråmalet beton (farvekode Ral 7038). Installation af el, netværk, VVS og trykluft sker via kanaler i hallens betongulv. Kanalernes indbyrdes afstand er 6 m.

Gulvet kan klare følgende belastninger:

Hjultryk (tvillingehjul)	5.500 kg/m ²
Punktbelastning fordelt på 15x15cm	4.000 kg
Max belastning (lastbil inkl. læs)	4.000 kg/m ²

Søjler

De fritstående søjler i hallen er 40x80cm og placeret for hver 9 meter. Søjlerne i ydervæggene er 35x40cm.

Brandskab og slangevinder – må ikke tildækkes.

Luft

Hal C har aircondition.

Hall C – a brief description

Accessing the hall

Please refer to the floorplan where access points are indicated.

Ceiling heights

Each of the four sections in hall C has its own ceiling height, measured from the floor to the lower edge of the lighting truss:

C1: 4.30m, C2: 5.85m, C3: 6.85m, C4: 6.85m.

Please see page 13-14.

General lighting

The hall is equipped with permanent lighting truss with 150W Powerball Spots, color 5000 kelvin. The solution is offered according to quote.

General hall light fittings (3x58 W)

Ceiling/suspension in the ceiling

Network cables will be supplied from the ceiling.

Drop wires: Most places in the hall we can mount drop wires with a weight up to 99 kg. Drop wires exceeding 50kg will require a special approval. Please contact your Technical Coordinator for calculations and approval.

Bella Center reserves the right to to customize location.

Hoist and rigging:

It is possible to use the truss for rigging. We are working with variable weight, depending on the total load of the ceiling.

The floorplan contains information about the location of the rigging points.

If You need suspension in a position between two rigging points, this can be achieved by either bridling or by hanging a rig-piece.

In general a maximum of 200 kg can be hung per rigging point.

Please see Rig Info on page 15.

If you need rigging, bridling or to hang a rig-piece, please contact your contact at Bella Center for options, validation and offers.

Bella Center reserves the right to to customize location.

Floor

The floor is concrete, painted light grey (color code Ral 7038). Power, plumbing, network and compressed air will, if possible, be supplied via the subfloor services ducts which are build-in the floor at 6 m intervals.

The floor can carry the following loads:

Wheel loads (twin wheels)	5,500 kg per sq.m.
Single point loads per 15x15cm	4,000 kg
Max loads (load incl. weight of truck)	4,000 kg per sq.m

Pillars

40x80cm freestanding concrete pillars line the arcade sections running east/west at intervals of 9m.

Pillars let into the outer walls measure 35x40cm wide.

Fire hose reel – must not be concealed.

Air

Hall C has air conditioning.

**BELLA ·
CENTER**
COPEN
HAGEN

HAL C Hall C

SCALE 1:750 - FORMAT A4

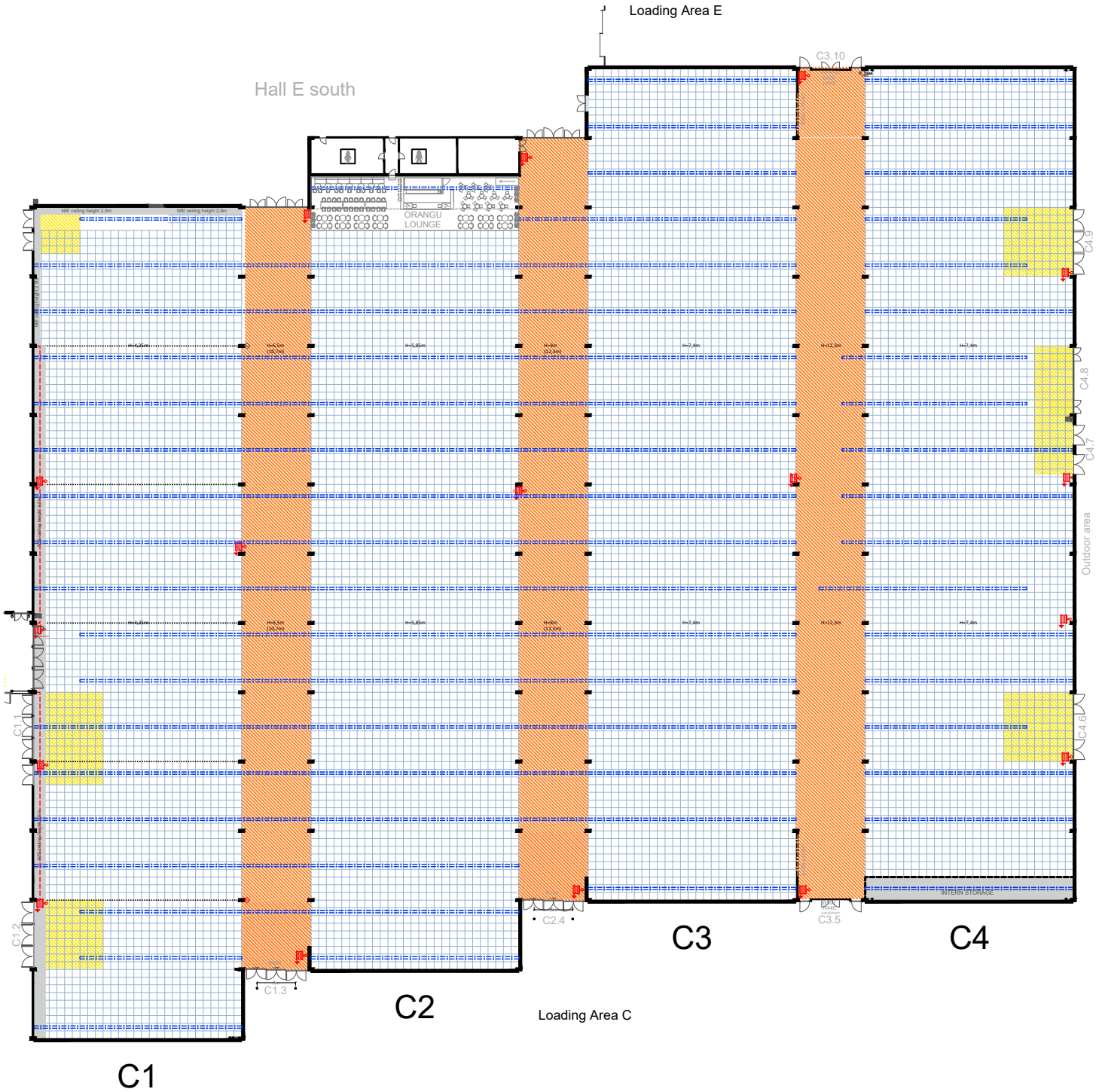
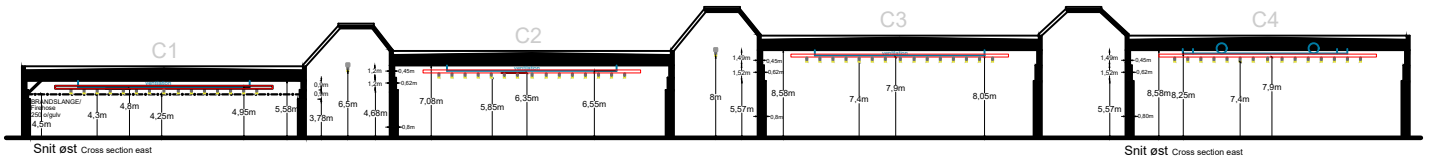
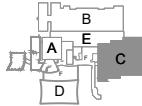

DETAILS Gulv/Floor



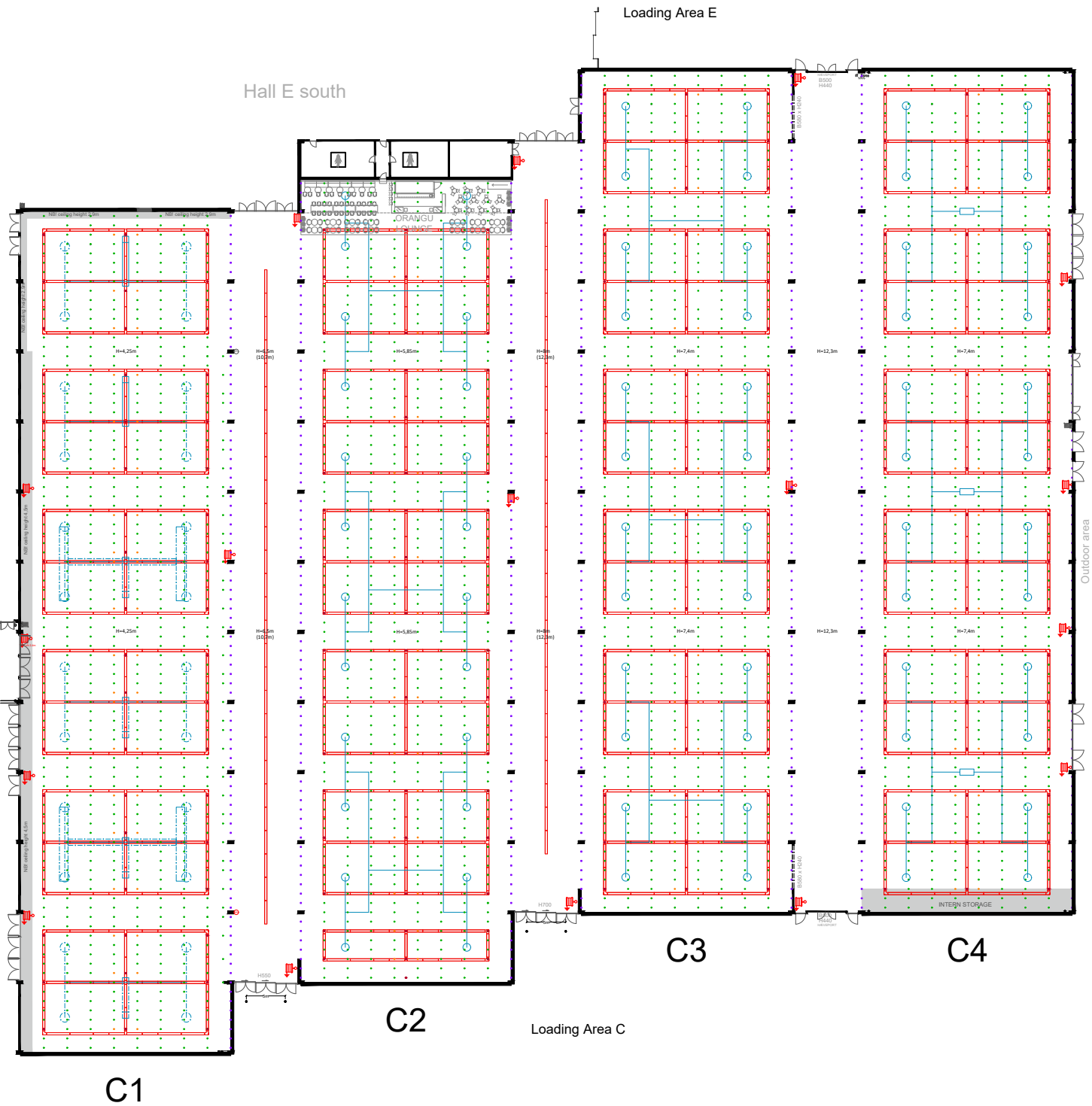
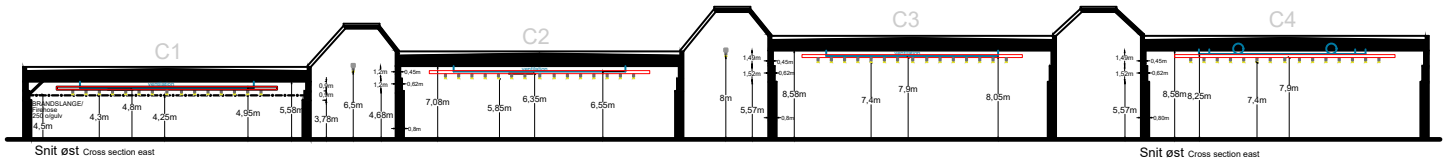
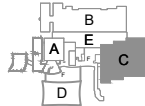

- | | | | | |
|---|--|---------------------------------------|--|--|
| 1x1m
GRID | BRANDTRYK
<i>Fire-alarm</i> | ELSKAB
<i>Power cabinet</i> | Brand Restriktions Zone:
-Gul-
Begrænset indretning
-Orange-
Særlige betingelser og restriktioner
-Rød-
Opbygning forbudt | Fire Restrictions Zone:
-Yellow-
Limited usage
-Orange-
Special conditions and restrictions
-Red-
All Build up prohibited |
| SØJLE 40x80CM
<i>Pillar 40x80cm</i> | SLANGEVINDER
<i>Fire-hose reel</i> | KABELGRAV
<i>Cable duct</i> | | |

HAL C Hall C

SCALE 1:750 - FORMAT A4

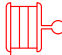

DETAILS Loft/Ceiling

-  BRANDTRYK
Fire-alarm
-  LYS RIG M/SPOTS
Lighting truss with spots
-  SØJLE 40x80CM
Pillar 40x80cm
-  SLANGEVINDER
Fire-hose reel
-  VENTILATION
Ventilation
-  RIGGEPUNKTER I LOFT
Rigging points in ceiling

HAL C Hall C

SCALE 1:750 - FORMAT A4

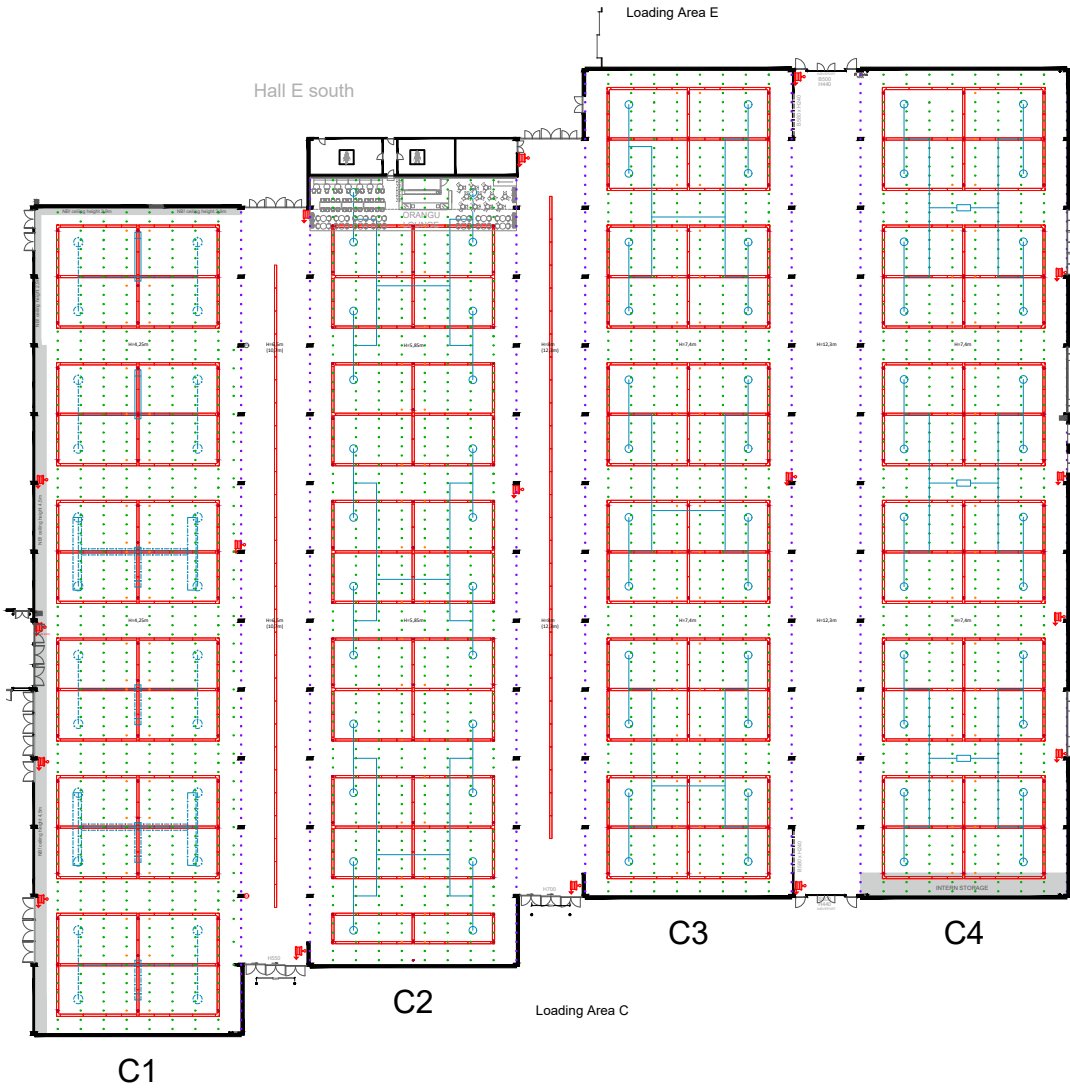
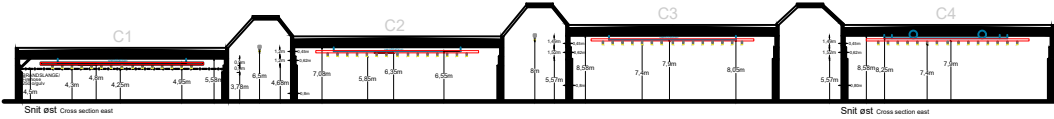
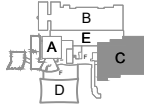

RIGGING INFORMATION

RIGGING INFO

NOTE (DK):

Rigging - sikkerheden i højsædet

På tegningen over C-hallen kan man se alle brugbare riggehuller. De er markeret med symbolet og man kan altid rigge direkte i dem med en vægt på op til 200 kg (Fig. 1).

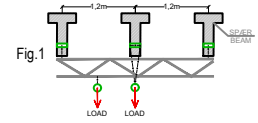

Hvis man har behov for ophæng i en position mellem to riggepunkter, kan det opnås med enten bridling (hvis riggehullerne er i samme spær - se Fig 2) eller ved at underhænge et rigestykke mellem to eller flere spær (Fig. 1). Hvis der er behov for et rigestykke, så kontakt din koordinator for et tilbud. Koordinatoren kan også vejlede generelt omkring mulighederne.

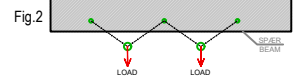

Rigge huller (afstand imellem spær 120cm)

- Grøn - 200kg
- Lilla - 200kg
- Orange - 50kg
- Red - TP er i brug til fast rig. Kan ikke belastes yderligere

Laster er totalaster inkl. talje beslag, rig mv. Ved horisontalt brug af rig huller kan der bridles (Fig 2) Ved vertikalt brug af rig huller skal der underhænges et rigestykke. (Fig. 1)

De riggehuller, der bruges til den permanente rig, kan ikke belastes yderligere.

Øvrige punkter kan belastes med 200kg pr. punkt.

NOTE (UK):

Rigging - safety first

The drawing of the C-hall shows all accessible rigging points indicated with the symbol All of these rigging points separately for rigging up to 200kg (Fig. 1).

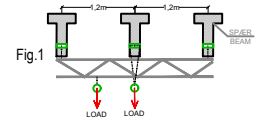

If you have a need for rigging between two rigging points, this can be solved by using bridling (if the points are in the same beam - Fig 2) or by adding a truss underneath two beams or more (Fig. 3). Please contact your coordinator for further inquiries and quotes.

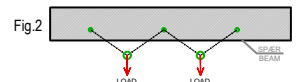

Rigging Points (Distance between beams 120cm)

- Green - 200kg
- Purple - 200kg
- Orange - 50kg
- Red - In use for permanent truss - no extra load allowed

Load is a total of chains, blocks, truss etc. Bridling is allowed between rigging points on the same beam. (Fig 2)

Bridling is not allowed between rigging points placed on adjacent beams. Specific rigging positions can still be achieved by hanging a truss underneath. (Fig. 1)

The rigging points already in use for the permanent truss cannot be exposed with extra load.

All other rigging points can be used for 200kg

DETAILS Loft/Ceiling

- BRANDTRYK
Fire-alarm
- LYS RIG M/SPOTS
Lighting truss with spots
- SØJLE 40x80CM
Pillar 40x80cm
- SLANGEVINDER
Fire-hose reel
- VENTILATION
Ventilation
- RIGGE PUNKTER I LOFT
Rigging points in ceiling